

Zhaga book18 series

Daylight sensor

Features

- Input voltage: 12-24V DC.
- Input current: $\geq 10\text{mA}$.
- *0-10V / PWM output signal.
- Super compact size($\phi 50$ only).
- Specially designed for UFO highbay fixtures, shoeboxes, wallpacks, simple plug and play.
- If the lighting fixture manufacturers / contractors do not want the daylight sensor function, they just need to easily remove the sensor head and put the cover cap on, the fixture becomes standard non-sensor control fixture.
- Intelligent photocell to measure and differentiate natural light from LED light.
- IR remote control, easy setting and user friendly.
- Operation temperature: $-20\text{ }^{\circ}\text{C} \sim +70\text{ }^{\circ}\text{C}$.
- RoHS compliant.
- IP rating: IP65.

Settings

The mated remote control for this model is IR14.

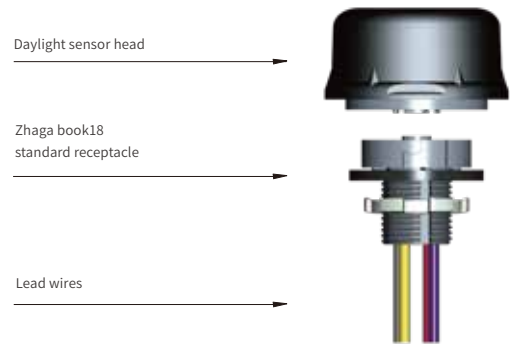

Model: HNP152DH

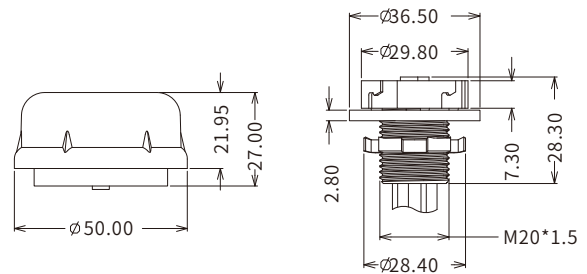

* Source current / Sink current: max. 20mA;
0-10V leads can not be short-circuit.

Easy operation for daylight harvest

step1

Choose the desired daylight sensor threshold, the daylight sensor will automatically switch on when surrounding brightness is below the chosen threshold. If surrounding brightness is over the threshold, the whole daylight sensor will not work at all.

step2

During operation, the daylight sensor regulates the light output automatically according to the level of surrounding brightness. The natural light goes up, the artificial light goes down; the natural light goes down, the artificial light goes up.

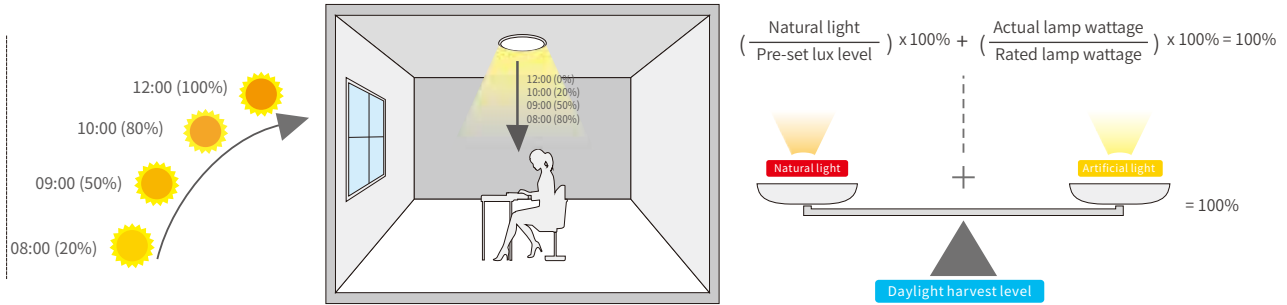

step3

The daylight sensor will automatically switch off when the natural light is confirmed sufficient (Lux-Off sampling time is 30s).

Note:

- 1 This special daylight sensor responds only to changes of natural light, any artificial light has no influence on its readings.
- 2 The formula & graphics above are just for end users to understand better how this daylight harvest sensor works roughly, No guarantee that all testing results in real application will be 100% matching.
- 3 Suggested setting for the daylight harvest level is 300lux, this value should suit most of general applications. If 300lux doesn't match nicely, pls try different values (higher or lower) to fit better for your specific application based on your actual on-site feelings.

PIN Description

PIN	Description	Lead wire color
1	12 - 24V DC input	Red
2	GND / DALI-	Grey
3	DALI+ (NC)	Yellow
4	0-10V+ / PWM output	Purple

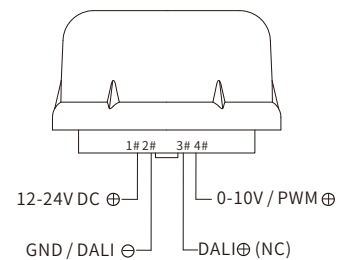
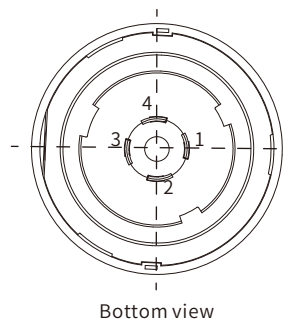

Wiring diagram

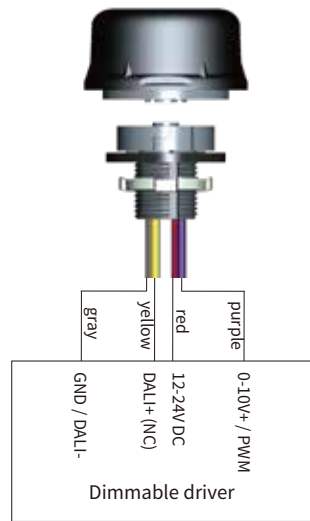

Daylight monitoring function

Utilizing the intelligent photocell, this daylight sensor can tell the difference of natural light and artificial light (lamp), switch on automatically when the ambient light is below target value, and then switch off automatically whenever the artificial light is not required (ambient light is bright enough).

This is the REAL & INTELLIGENT daylight monitoring sensor.

Note:

Lux-Off sampling time--30s; Lux-On sampling time--10s.

