

## Foreword

Thanks for choosing our LED Panel Light. We strongly recommend you to read this manual carefully before installation and usage. Make sure you have completely understood the assembly instructions so as to ensure normal working of LED Panel Light.

## Safety Warnings

In order to ensure a perfect quality of the product and a safe usage, please kindly follow the instructions:

1. Before opening the package, please check if there's damage or defect during transportation, if damage occurs, please don't use it and inform your supplier immediately.
2. Should the product be found damaged in any way, please keep it in package and contact your supplier in time.
3. Please do not attempt to use a damaged product.
4. The product should be installed, dismantled and maintained by a qualified electrician; Suppliers don't take charge of any problems or damages that occur due to mishandling such as an operation not permitted in this manual.
5. Choose an install place where can withstand 10 times the weight of the product to ensure a solid installation.
6. Wipe the lampshade and veil with soft cloth dipped a little neutral detergent, be sure not to use any sandpaper, polishing powder or alcohol, gasoline and so on liquor.
7. Don't connect cables with powered-on; make sure a correct connection and no short circuit checked with instrument before powered-on.
8. If the external flexible cable or cord of this luminaire is damaged, it shall be replaced by a special cord or cord exclusively available from the manufacturer or his service agent.
9. Indoor use only.

This manual applies to this model product only, for more information, please contact our staff.

# USER MANUAL

## LED Panel Light

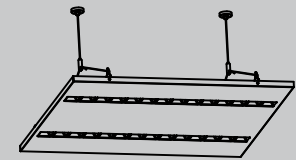

Suspended Installation

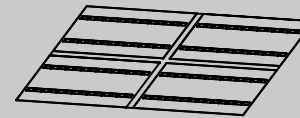

Recessed Installation

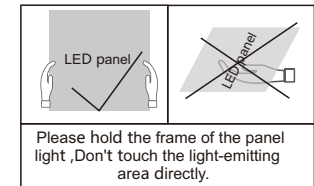

## CONTENTS

Product Parameter	1
Product dimension(mm)	1
Installation	2
Foreword	3
Safety Warnings	3

## Product Parameters

Operating temperature:-10°C~ +40°C

The power input voltage should be based on the product label.

Item	Input	Power	L x W x H	Weight
FK-PX6060-XXE-ME1	220-240VAC	36 W	595*595*18 mm	2.5 kg

## Product dimension(mm)

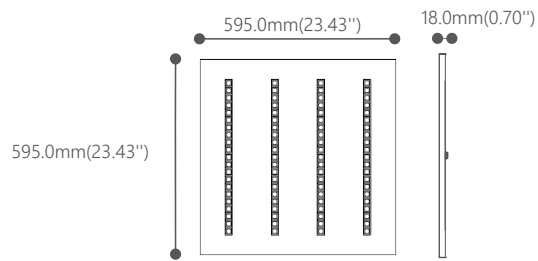

## Suspended Installation

1.Necessary accessories.

2.Fix the hanging wires onto ceiling in order with expansion bolts.

3.Hang the hook of the lifting rope into the holes at the four corners of the panel light , adjusting suitable distance between two ends to make sure panel light is located in horizontal level safely.

PWB3x6 Screws\*4PCS

Expansion bolt \* 4PCS

Hanging wire \* 2PCS

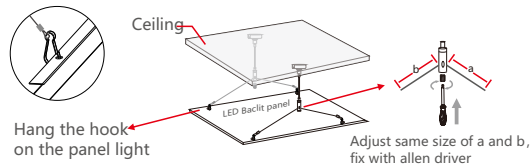
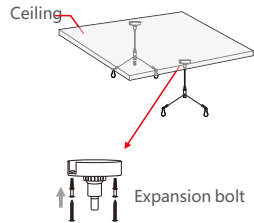

4.Adjust the length of stainless wire to the suitable height.

## Recessed Installation

1 .Take out the false ceiling block that are identical size as panel light.

2.Wiring driver and all other necessary accessories.

3.Fix the panel light into right place, Power on.

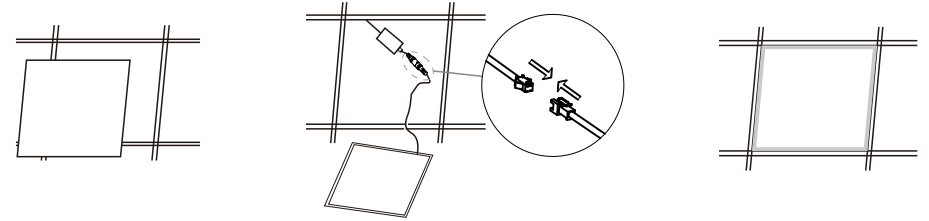

## 5CCT Regulation

3 CCT- in- 1 panel, adjusted with DIP switch to meet different CCT requirement.

